

# Speech Room Assignments

**Creative Expression**  
 Prelim Rounds: . . . . . Rooms 206, 208, 210, 212  
 Final Round: . . . . . Room 167 - Band

**Discussion**  
 Prelim Rounds: . . . . . Rooms 303, 305, 307, 309  
 Final Round: . . . . . Room 303

**Duo Interpretation**  
 Prelim Rounds: . . . . . Rooms 100, 167, 171, Auditorium  
 Final Round: . . . . . Auditorium

**Extemporaneous Reading**  
 Draws: . . . . . Media Center  
 Prelim Rounds: . . . . . Rooms 202, 236, 238, 240  
 Final Round: . . . . . Room 240

**Extemporaneous Speaking**  
 Draws: . . . . . Media Center  
 Prelim Rounds: . . . . . Rooms 226, 230, 232, 234  
 Final Round: . . . . . Room 230

**Great Speeches**  
 Prelim Rounds: . . . . . Rooms 111, 120, 122, 124  
 Final Round: . . . . . Room 106

**Humorous Interpretation**  
 Prelim Rounds: . . . . . Rooms 200 A, 200 B, 200 C, 200 D  
 Final Round: . . . . . Room 171 - Choir

**Informative Speaking**  
 Prelim Rounds: . . . . . Rooms 101, 102, 106, 123  
 Final Round: . . . . . Room 102

**Original Oratory**  
 Prelim Rounds: . . . . . Rooms 115, 121, 136, 138  
 Final Round: . . . . . Room 115

**Serious Interpretation – Drama**  
 Prelim Rounds: . . . . . Rooms 300 A, 300 B, 300 C, 300 D  
 Final Round: . . . . . Room 322

**Serious Interpretation – Poetry**  
 Prelim Rounds: . . . . . Rooms 332, 334, 336, 338  
 Final Round: . . . . . Room 336

**Serious Interpretation – Prose**  
 Prelim Rounds: . . . . . Rooms 100 A, 100 B, 100 C, 100 D  
 Final Round: . . . . . Rooms 107, 109

**Storytelling**  
 Draws: . . . . . Media Center  
 Prelim Rounds: . . . . . Rooms 216, 218, 220, 224  
 Final Round: . . . . . Room 100 - Orchestra

**Administrative Rooms**  
 Tournament Headquarters . . . . . CRC  
 Jury Meeting Room . . . . . CRC  
 Judges Lounge . . . . . Rooms 191, 192  
 Coaches Lounge . . . . . Forum Room

**Student Gathering** – Main Commons  
**Final Round Postings** – Screens in Commons  
**Concessions/Merchandise** – South Gymnasium  
**Awards** – South Gymnasium





# Speech Room Assignments

## SECOND FLOOR

## THIRD FLOOR

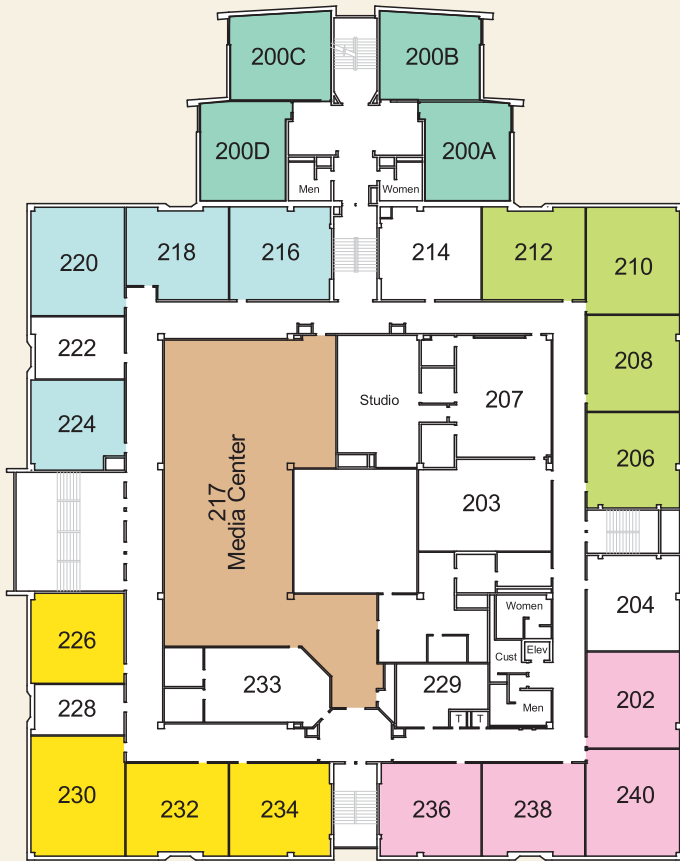

## LOWER LEVEL

